

SEAN

PLASTIC srl

STAMPAGGIO AD INIEZIONE MATERIE PLASTICHE
COSTRUZIONE STAMPI

Injection Molding
Mould Design and Construction

Meccanoplast

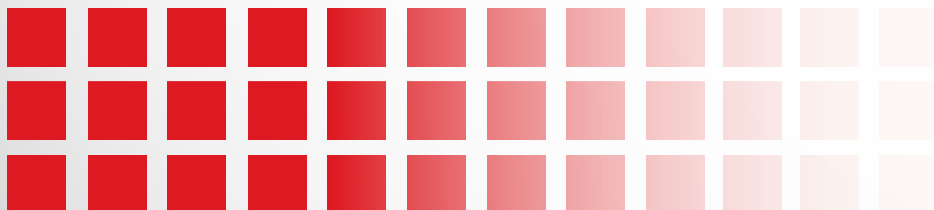

TU-BOX EVOLUTION MEDIUM™

TASCA PORTADOCUMENTI MANUAL HOLDER



ART. MP02100

Tipo / Size: "Evolution Medium"
Materiale / Material: polipropilene
Misure / Overall Dimensions:

- A: 325 mm.
- B: 90 mm.
- C: 266 mm.
- G: 8,2 mm.

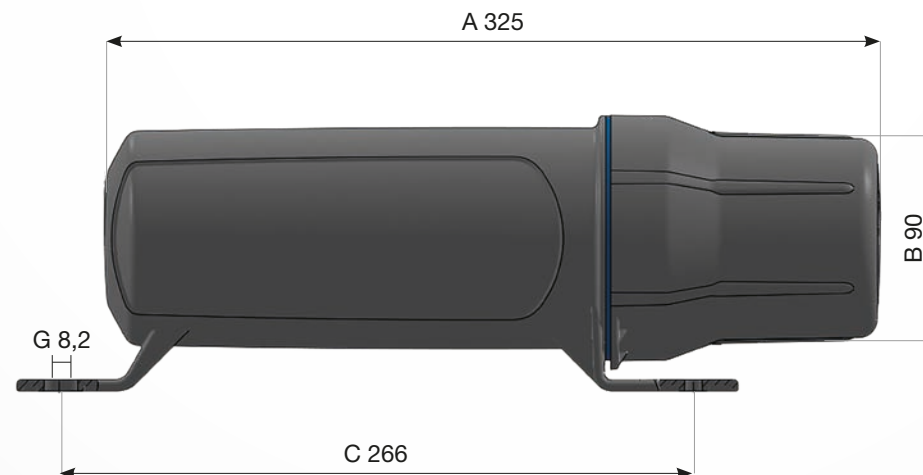

**POSSIBILITÀ DI
CHIUSURA CON
LUCCHETTO**
**POSSIBILITY OF
CLOSURE WITH
PADLOCK**

**LUCCHETTO NON
INCLUSO, FORNIBILE
A RICHIESTA**
**PADLOCK NOT
INCLUDED, SUPPLIED
ON REQUEST**

TU-BOX EVOLUTION BIG™

TASCA PORTADOCUMENTI MANUAL HOLDER

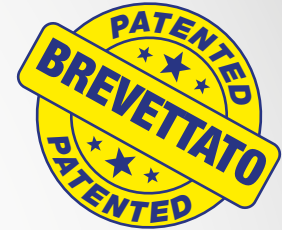

ART. MP02600

Tipo / Size: "Evolution Big"

Materiale / Material: polipropilene

Misure / Overall Dimensions:

- A: 328 mm.
- B: 114 mm.
- C: 266 mm.
- H: 8,2 mm.

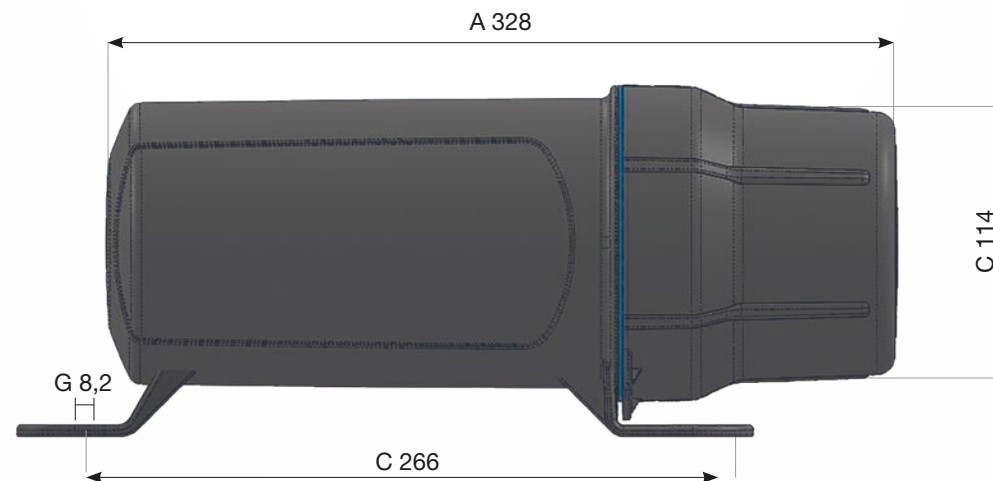

**POSSIBILITÀ DI
CHIUSURA CON
LUCCHETTO
POSSIBILITY OF
CLOSURE WITH
PADLOCK**

**LUCCHETTO NON
INCLUSO, FORNIBILE
A RICHIESTA
PADLOCK NOT
INCLUDED, SUPPLIED
ON REQUEST**



ART. MP01666

Tipo / Size: "Mini"

Materiale / Material: polipropilene

Misure / Overall Dimensions:

- A: 320 mm.
- B: 55 mm.
- C: 266 mm.
- G: 8 mm.



ART. MP01848

Tipo / Size: "Medium"

Materiale / Material: polipropilene

Misure / Overall Dimensions:

- A: 320 mm.
- B: 85 mm.
- C: 266 mm.
- G: 8 mm.



ART. MP01671

Tipo / Size: "Big"

Materiale / Material: polipropilene

Misure / Overall Dimensions:

- A: 320 mm.
- B: 115 mm.
- C: 266 mm.
- G: 8 mm.

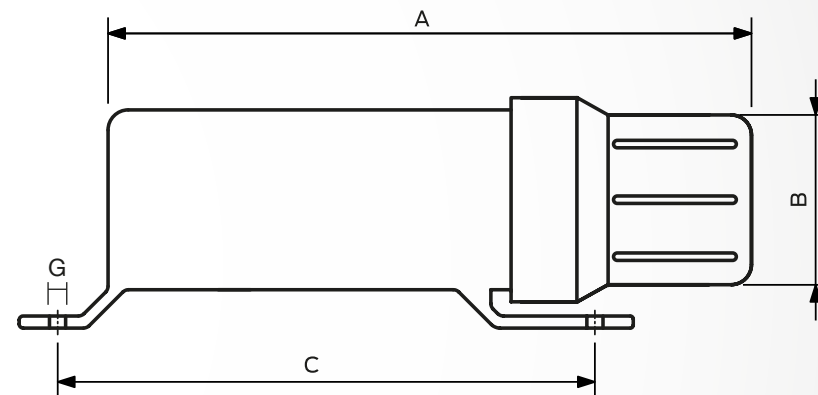

Meccanoplast

TASCA PORTADOCUMENTI MANUAL HOLDER



ART. MCPAB/101

Tipo / Size: "Mini"

Materiale / Material: polipropilene

Misure / Overall Dimensions:

- A: 317 mm.
- B: 72 mm.
- C: 266 mm.
- G: 8,7 mm.



ART. MCPAA/101

Tipo / Size: "Medium"

Materiale / Material: polipropilene

Misure / Overall Dimensions:

- A: 315 mm.
- B: 102 mm.
- C: 160 mm.
- D: 27 mm.
- E: 26,5 mm.
- F: 43 mm.



ART. MCPAA/201

Tipo / Size: "Medium"

Materiale / Material: polipropilene

Misure / Overall Dimensions:

- A: 315 mm.
- B: 102 mm.
- C: 266 mm.
- G: 8,7 mm.



ART. MCPAC/101

Tipo / Size: "Big"

Materiale / Material: polipropilene

Misure / Overall Dimensions:

- A: 320 mm.
- B: 133 mm.
- C: 266 mm.
- G: 8,7 mm.

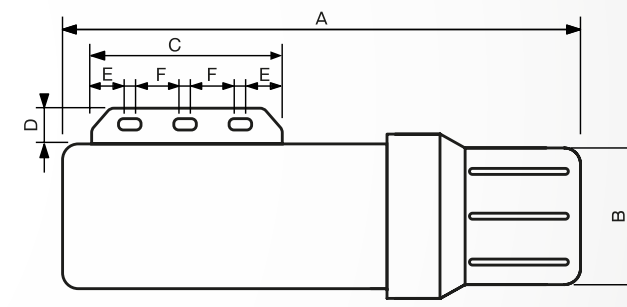
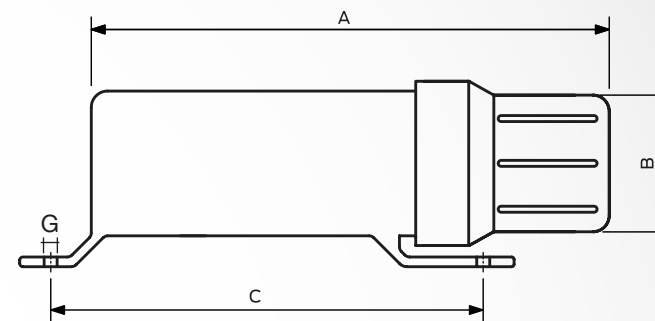

DOCU-BOX™

TASCA PORTADOCUMENTI MANUAL HOLDER

PREDISPOSIZIONE PER
CHIUSURA CON LUCCHETTO
ACCOMMODATION FOR LOCK

ORECCHIE PER
APERTURA
FACILITATA
SIDE LIPS FOR
EASY OPENING

POSSIBILITÀ DI
PERSONALIZZAZIONE
CON LOGO CLIENTE
OPTION FOR
CUSTOMER LOGO

CERNIERA
INTEGRATA A TENUTA
INTEGRATED HINGE

**MATERIALE
RESISTENTE
A -35° E +90°
E RAGGI UV**

**TEMP. RANGE
-35°, +90°
UV RESISTANT
MATERIAL**



AMPIA CAPIENZA
INTERNA PER
DOCUMENTI
IN FORMATO A4
LARGE STORAGE
FOR THICK A4 SIZE
DOCUMENTS

GUARNIZIONI
IN GOMMA
PER TENUTA
ALL'ACQUA
WATER PROOF
RUBBER SEAL

ART. MP01900

Materiale / Material: polipropilene
Misure / Overall Dimensions:

- A: 280 mm.
- B: 375,5 mm
- C: 57 mm
- D: 8,50 mm
- E: 150 mm
- F: 180 mm



TASCA DI MANTENIMENTO
TRAFORATA PER
VISIBILITÀ CONTENUTO
PERFORATED HOLDER
TO ALLOW VISIBILITY



Meccanoplast

TASCA PORTADOCUMENTI MANUAL HOLDER

**PREDISPOSIZIONE PER
CHIUSURA CON LUCCHETTO
ACCOMMODATION FOR LOCK**

**GUARNIZIONE IN
NEOPRENE PER UNA
CHIUSURA ERMETICA
CLOSES HERMATICALLY
THANKS TO THE
NEOPRENE SEALS**

**FORI PER IL FISSAGGIO
SOLIDALE ALLA MACCHINA
HOLES FOR FASTENING
SECURELY TO YOUR VEHICLE**



**LINGUETTA DI
CHIUSURA
FASTENING TAB**

ART. MCPBA/201

Formato/Size: A5

Materiale / Material: polipropilene

Misure / Overall Dimensions:

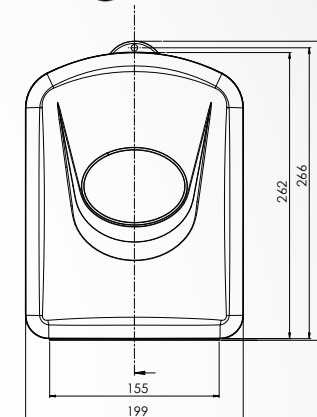
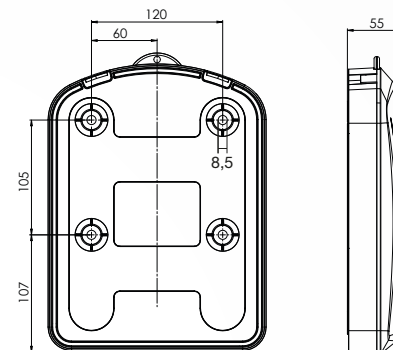

F.to A5

ART. MCPBA/101

Formato/Size: A4

Materiale / Material: polipropilene

Misure / Overall Dimensions:

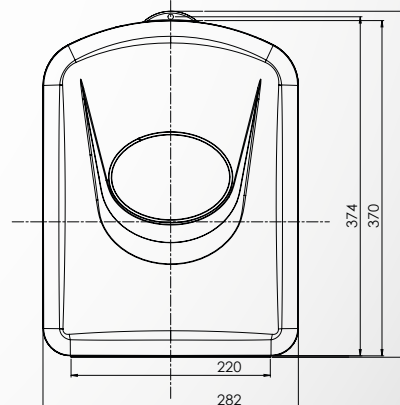
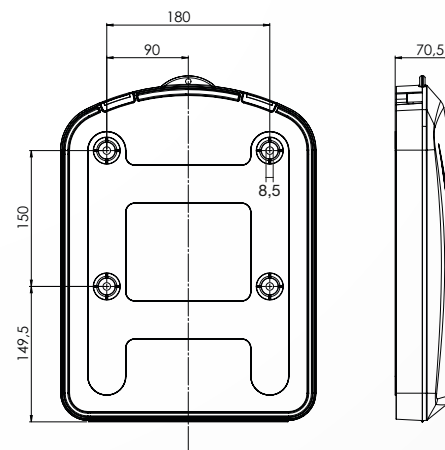

F.to A4

TOOL-BOX

CASSETTA PORTA ATTREZZI TOOL-BOX



- Elegante design personalizzabile a richiesta con logo tampografato
- Forma moderna ed ergonomica
- 100% materiale polipropilene riciclabile
- Due cerniere di chiusura + aggancio per lucchetto.
- Corpo resistente anche in condizioni di caldo e freddo

- *Elegant design, upon request it can be customized with your own log tampo printed*
- *Ergonomic and modern shape*
- *100% polypropylene recyclable*
- *2 fixing lock and on safety lock*
- *Strong body, cold and heat resistant*



ART./REF.

DESCRIZIONE/ DESCRIPTION

35070

CASSETTA PORTA ATTREZZI GRANDE
TOOL BOX BIG SIZE

35067

CASSETTA PORTA ATTREZZI PICCOLA
TOOL BOX SMALL SIZE



TOOL-BOX

CASSETTA PORTA ATTREZZI TOOL-BOX

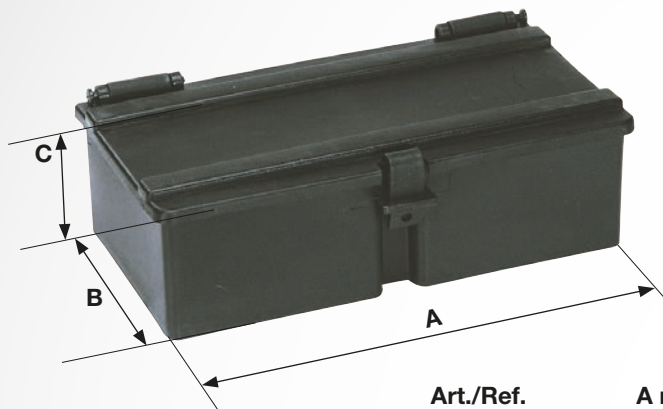

Art./Ref.	A mm	B mm	C mm
01227	270	151	90
01228	270	151	136

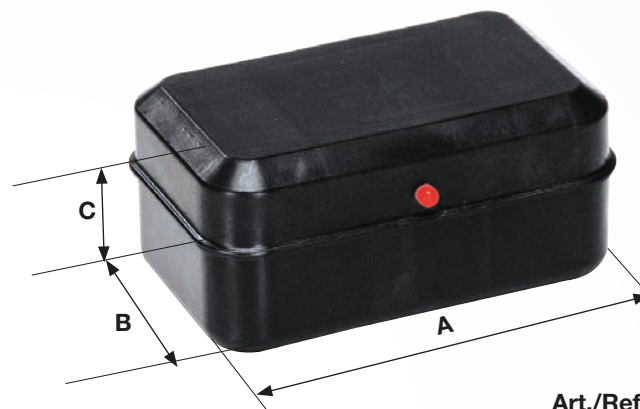

Art./Ref.	A mm	B mm	C mm
01329	165	70	100
01330	240	65	110

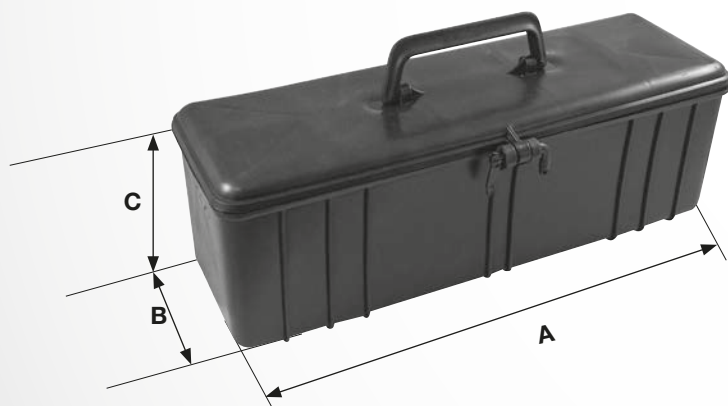

Art./Ref.	A mm	B mm	C mm
01398	420	125	125

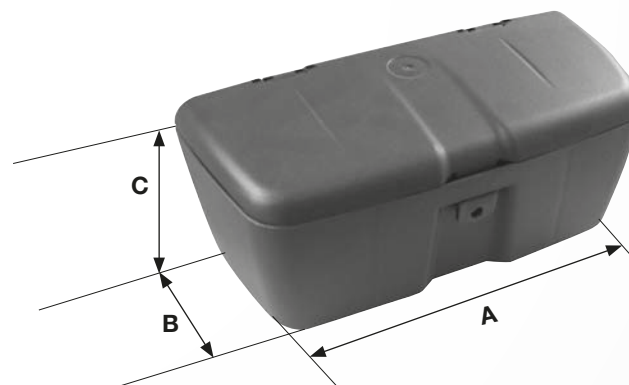

Art./Ref.	A mm	B mm	C mm
95923	370	140	130

R360 CUNEO PICCOLO PLASTIC CHOCK

NEW

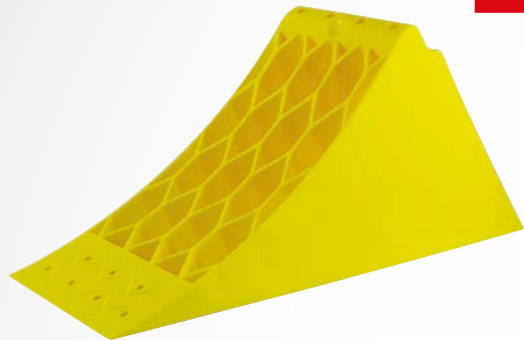

Omologato/Homologation **DIN 76051 - G36**

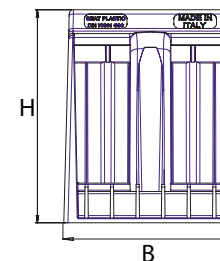
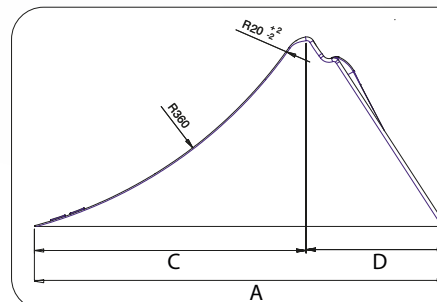

ART./REF.	DESCRIZIONE/DESCRIPTION	A mm	B mm	C mm	D mm	H mm	R mm
MP02891	Cuneo fermaruota in plastica raggio 360 <i>Plastic chock 360</i>	328	124	225	103	151	360

NEW

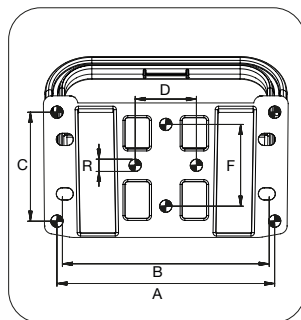

ART./REF.	DESCRIZIONE/DESCRIPTION	A mm	B mm	C mm	D mm	E mm	F mm	R mm
MP02888	Porta cuneo R360 con maniglia <i>Plastic chock holder R360</i>	163	155	81,5	46	41	61	9

NEW

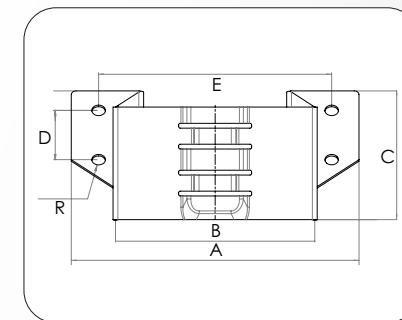
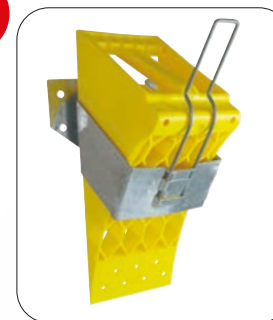

ART./REF.	DESCRIZIONE/DESCRIPTION	A mm	B mm	C mm	D mm	E mm	R mm
OMP0360	Porta cuneo R360 in metallo <i>Galvanized chock holder R360</i>	179	124	80	40	145	4,25

R460 CUNEO GRANDE PLASTIC CHOCK

NEW



Omologato/Homologation **DIN 76051 - G36**

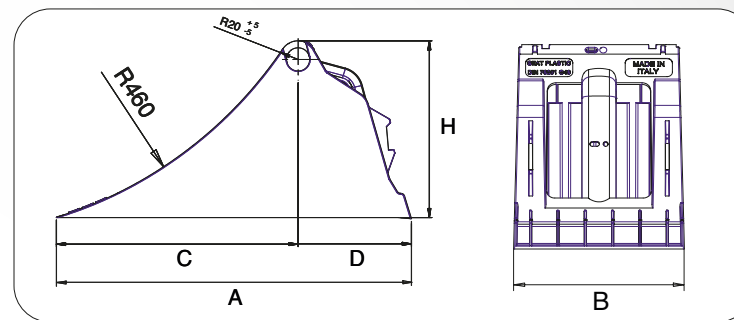

ART./REF.	DESCRIZIONE/DESCRIPTION	A mm	B mm	C mm	D mm	H mm	R mm
MP02890	Cuneo fermaruota in plastica raggio 460 <i>Plastic chock 460</i>	385	161	265	120	192	460

NEW

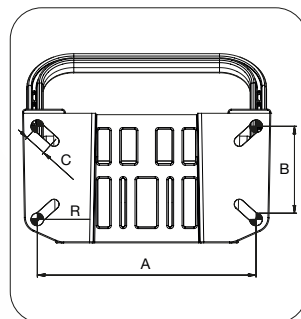

ART./REF.	DESCRIZIONE/DESCRIPTION	A mm	B mm	C mm	R mm
MP02889	Porta cuneo R460 con maniglia <i>Plastic chock holder R460</i>	214	85	22	6,25

NEW

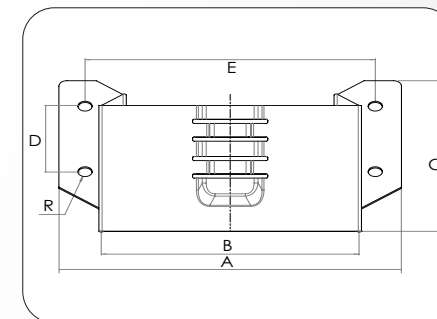

ART./REF.	DESCRIZIONE/DESCRIPTION	A mm	B mm	C mm	D mm	E mm	R mm
OMP0460	Porta cuneo R460 in metallo <i>Galvanized chock holder R460</i>	216	163	110	60	183	4,50

SECUR-PTO™

CONTROCUFFIE E GUAINE PER PRESE DI FORZA *PTO Shaft Cone and PTO Caps*



CONTROCUFFIA TIPO MEZZO TRONCO A 45°
Trunk Cylindrical 45°
C0501 (ex MCP13/201)

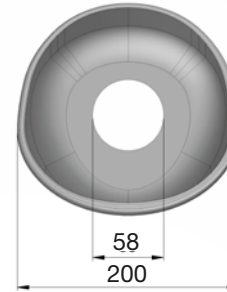

CONTROCUFFIA CILINDRICA
Cylindrical shaft cone
C0781 (ex MCP50/111)

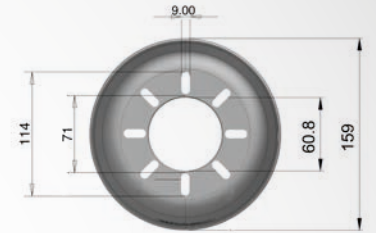
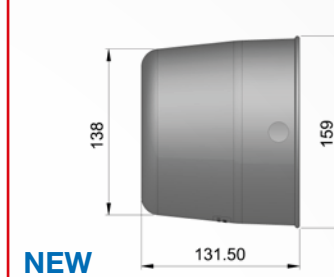

CONTROCUFFIA CONICA CON ATTACCO FASCETTA
Shaft Cones Cone- Shaped with Joint Band
C0604 (ex MCP18/101)

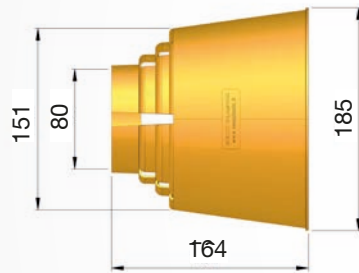

CONTROCUFFIA CILINDRICA CON COLLARE
Cylindrical shaft cone with collar
C0801 (ex MCP50/101)

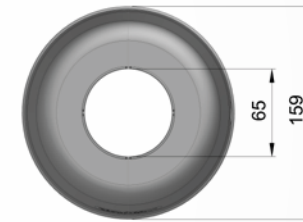
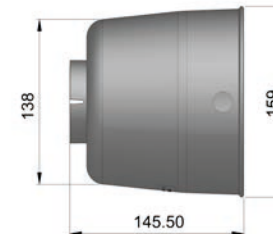

CONTROCUFFIA TONDA MINI / Mini Rounded Shaft Cone
C0101 (ex MCP70/141)

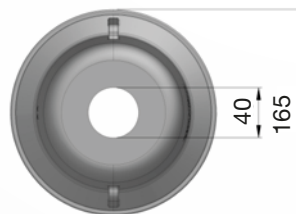
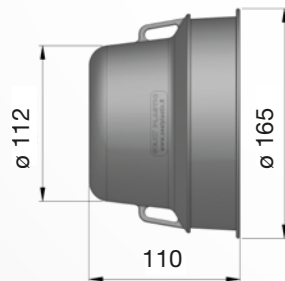

C0101C1 (ex MCP70/241)

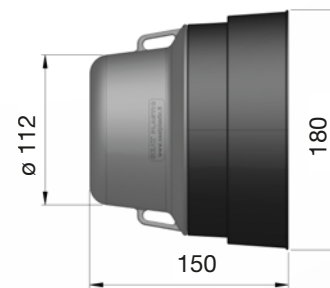

SECUR-PTO™

CONTROCUFFIE E GUAINE PER PRESE DI FORZA PTO Shaft Cone and PTO Caps



COPERCHIO CUFFIA
Lid for shaft cone

MCP38/201

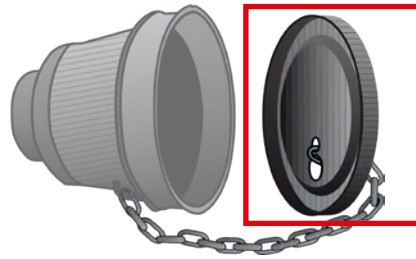
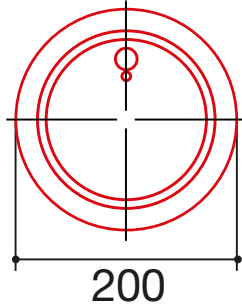

CONTROCUFFIA SAGOMATA
Shaped shaft cone
MCP13/101

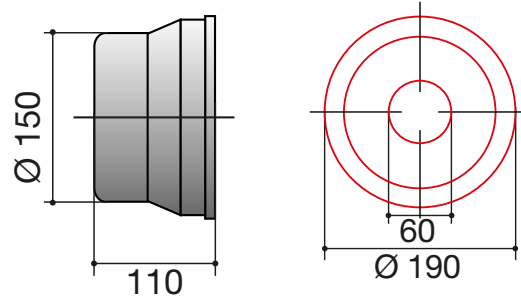

CONTROCUFFIA CON COLLARE
Shaft cone with collar
MCP35/41

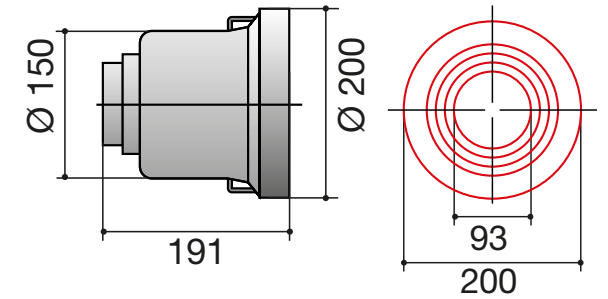

CATENA PER COPERCHI
Lid chain

Art./Ref.	Lunghezza/Lenght
MCP38/A1	240 mm
MCP38/A2	450 mm



CONTROCUFFIA APERTURA LATERALE
Shaft cone with lateral window

MCP75/111

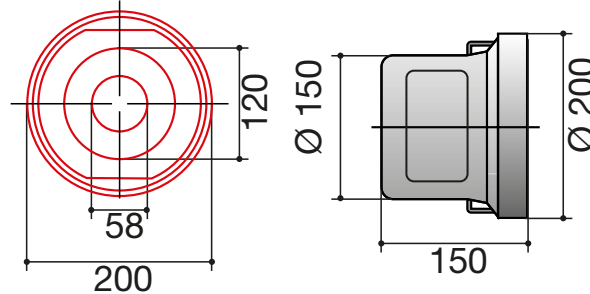



CONTROCUFFIA TONDA PICCOLA MODELLO STANDARD / Standard Small Model Shaft Cone

C0201 (ex MCP43/101)
C0281*

C0201C4 (ex MCP43/201)
C0281C4*

C0201L4 (ex MCP43/211)
C0281L4*

Optional

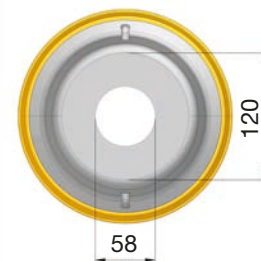
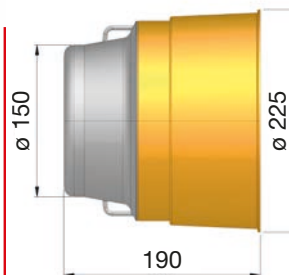
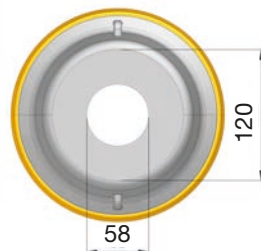
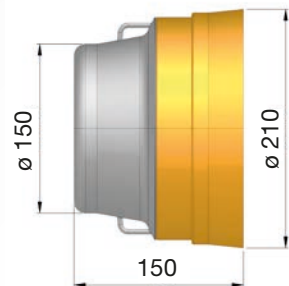
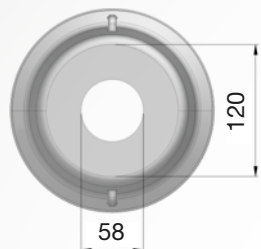
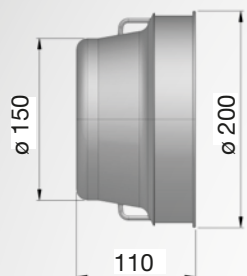

Cod.8 *

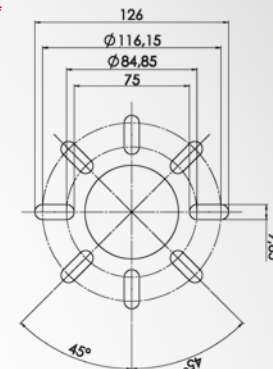

CONTROCUFFIA TONDA MEDIA MODELLO STANDARD / Standard Medium Model Shaft Cone

C0301 (ex MCP35/101)
C0381*

C0301C4 (ex MCP35/201)
C0381C4*

C0301L4 (ex MCP35/221)
C0381L4*

Optional

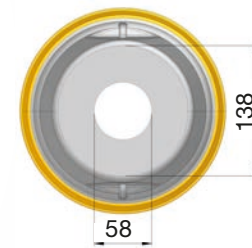
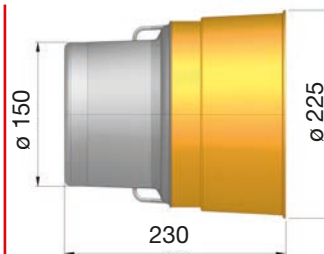
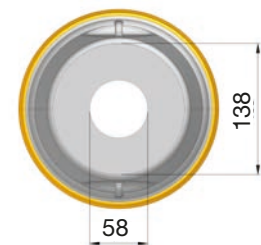
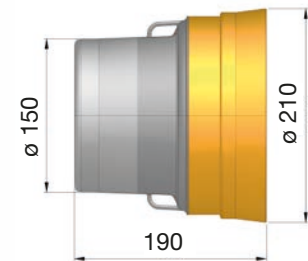
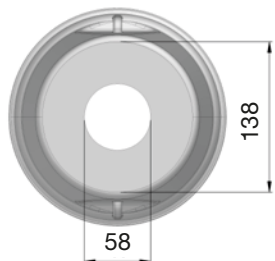
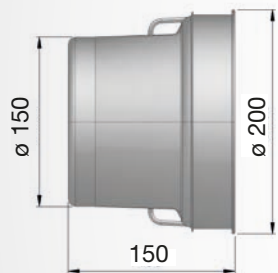

Cod.8 *

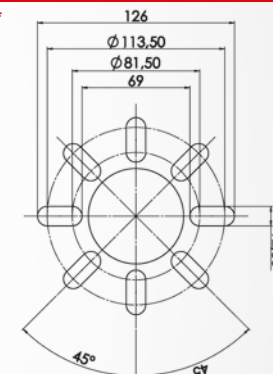

CONTROCUFFIA TONDA GRANDE MODELLO STANDARD / Standard Big Model Shaft Cone

C0401 (ex MCP30/101)
C0481*

C0401C4 (ex MCP30/201)
C0481C4*

C0401L4 (ex MCP30/221)
C0481L4*

Optional

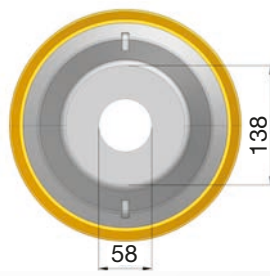
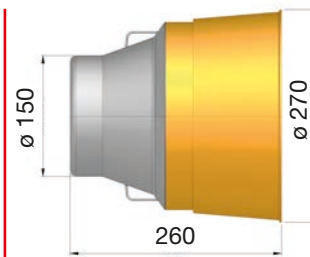
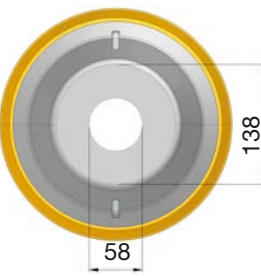
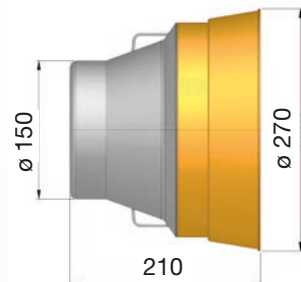
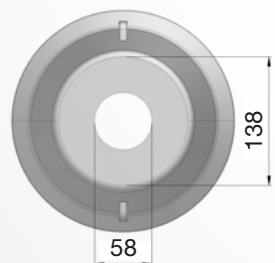
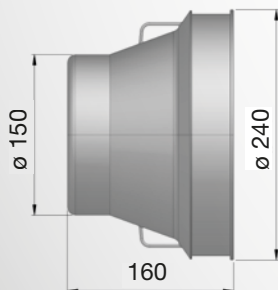

Cod.8 *

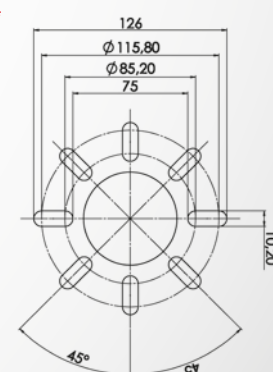

Meccanoplast



CONTROCUFFIA OVALE / Oval Shaft Cone

MCP65/101

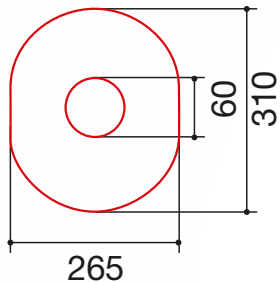
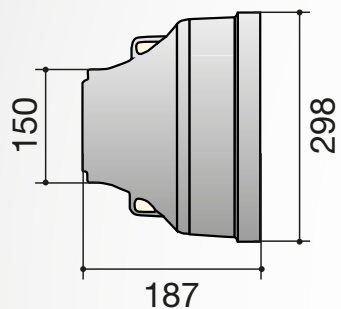

CONTROCUFFIA OVALE con fascia / Oval Shaft Cone with extention

MCP65/201

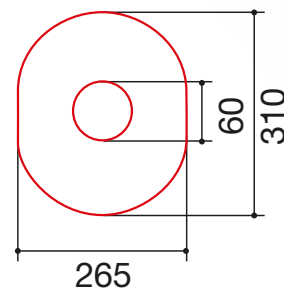
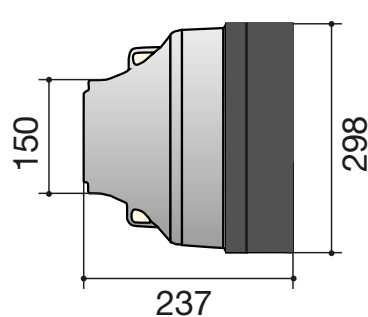

CONTROCUFFIA OVALE / Oval Shaft Cone

MCP76/101

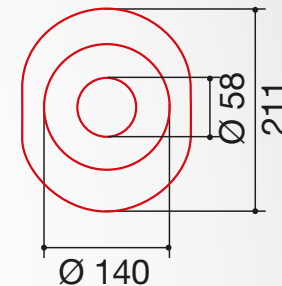
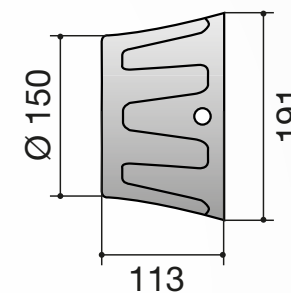

CONTROCUFFIA OVALE COMPLETA DI COPERCHIO E CATENELLA / Oval shaft cone with chain and lid

MCP76/211

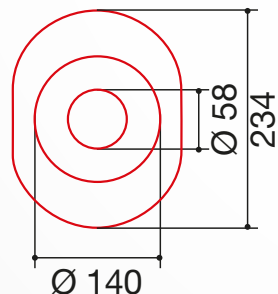
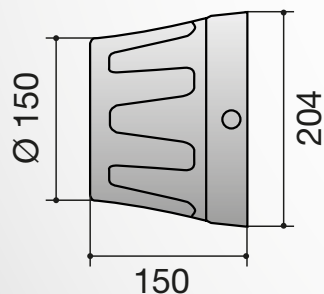

CONTROCUFFIA OVALE / Oval Shaft Cone

MCP76/201

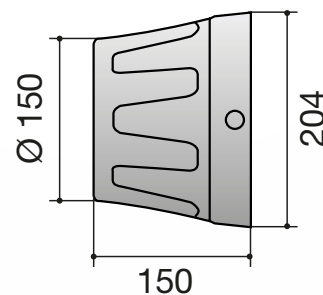

COPERCHIO PER MCP76/201 / Lid for MCP76/201

MCP77/101

CATENA 110mm / Chain 110 mm

MCP38/A3

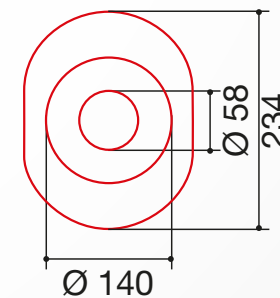



CONTROCUFFIA OVALE MODELLO STANDARD / Standard Oval Model Shaft Cone

C1004 (ex MCP36/101)
C1084*

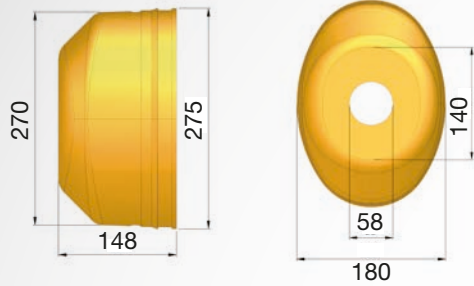

C1004C1 (ex MCP36/201)
C1084C4*

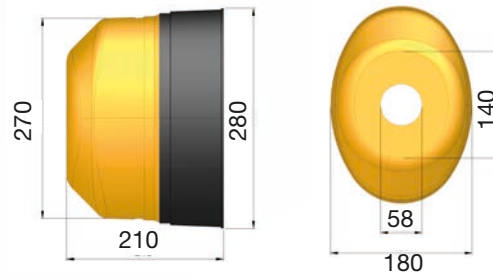

C1004L1 (ex MCP36/301)
C1084L4*

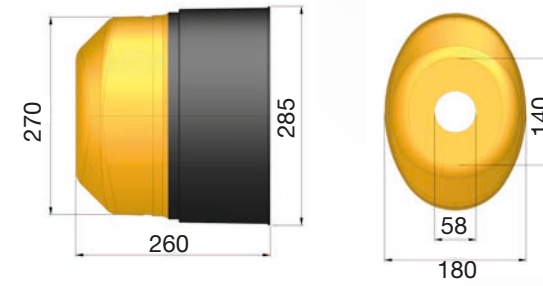

Optional

Cod.8 *

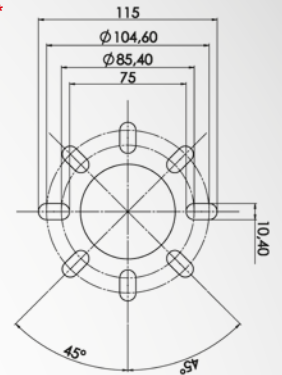

CONTROCUFFIA OVALE MOD. STANDARD: UNO SPORTELLO / Standard Oval Model Shaft Cone: Single Window

C1104 (ex MCP36/111)
C1184*

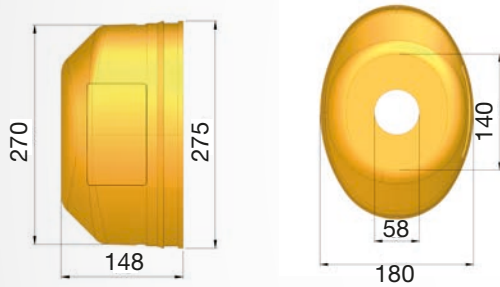

C1104C1 (ex MCP36/211)
C1184C4*

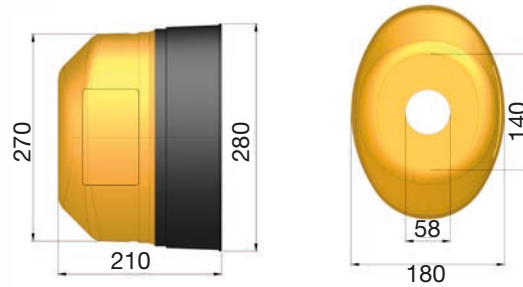

C1104L1 (ex MCP36/311)
C1184L4*

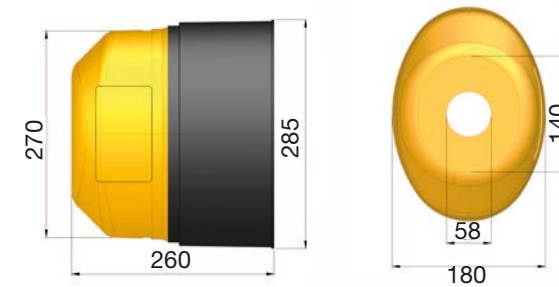

Optional

Cod.8 *

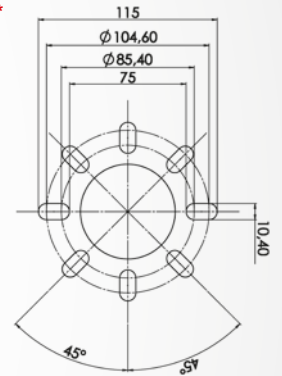

CONTROCUFFIA OVALE MOD. STANDARD: DUE SPORTELLI / Standard Oval Model Shaft Cone: Dual Windows

C1204 (ex MCP36/171)
C1284*

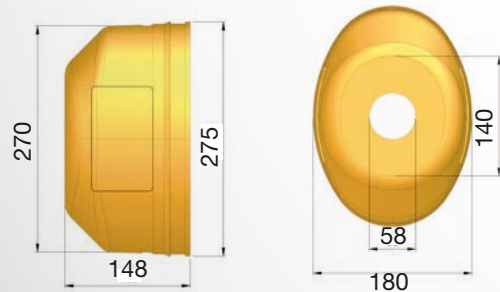

C1204C1 (ex MCP36/271)
C1284C4*

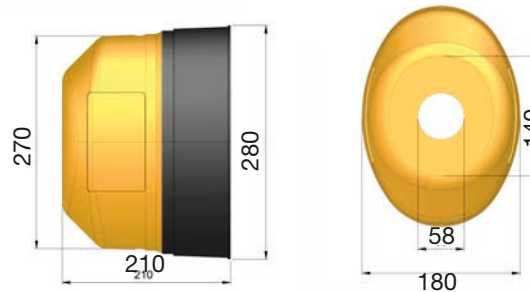

C1204L1 (ex MCP36/371)
C1284L4*

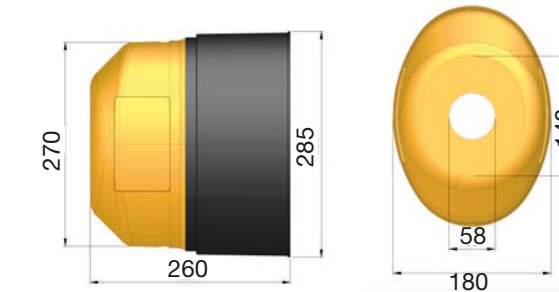

Optional

Cod.8 *

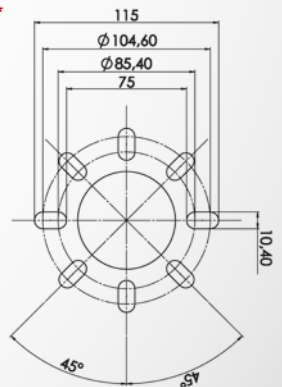



CONTROCUFFIA OVALE TIPO BOMBETTA / Oval Medium Model Shaft Cone

C2001 (ex MCP55/101)
C2081* e C2091+

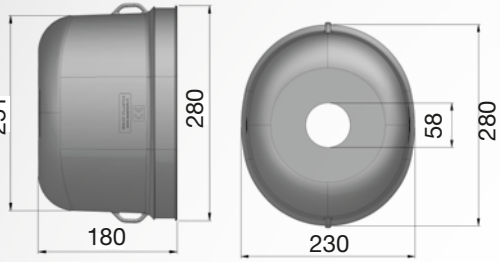

NEW

C2001C1 (ex MCP55/201)
C2081C1* e C2091C1+

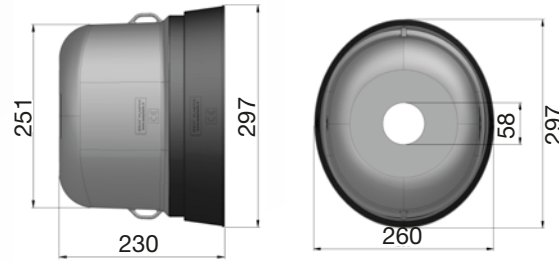

C2001L1 (ex MCP55/301)
C2081L1* e C2091L1+

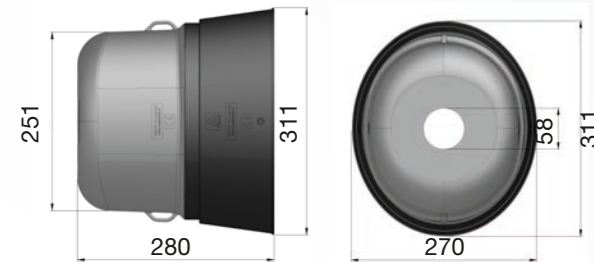

Optional

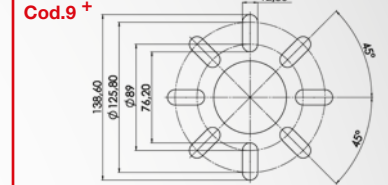
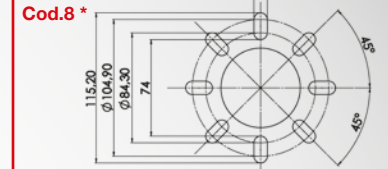

CONTROCUFFIA OVALE TIPO BOMBETTA: UNO SPORTELLO / Oval Medium Model Shaft Cone: Single Window

C2101 (ex MCP55/111)
C2181* e C2191+

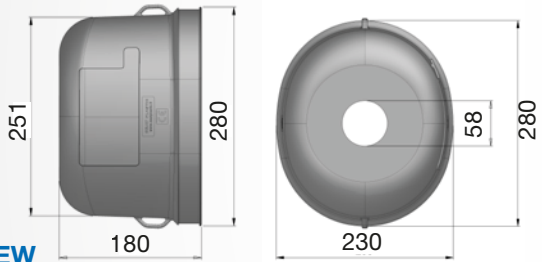

NEW

C2101C1 (ex MCP55/211)
C2181C1* e C2191C1+

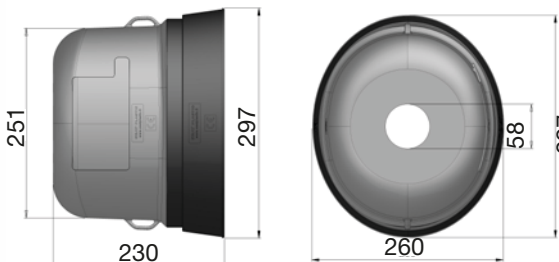

C2101L1 (ex MCP55/311)
C2181L1* e C2191L1+

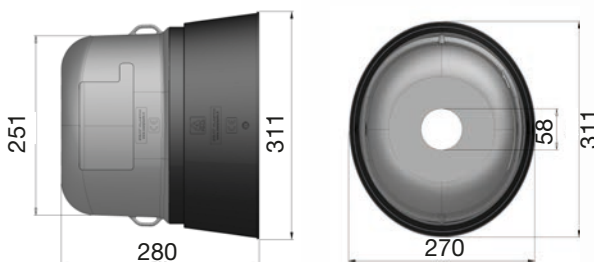

Optional

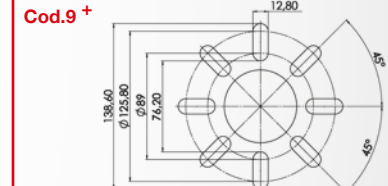
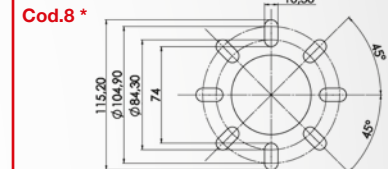

CONTROCUFFIA OVALE TIPO BOMBETTA: DUE SPORTELLI / Oval Medium Model Shaft Cone: Dual Windows

C2201 (ex MCP55/171)
C2281* e C2291+

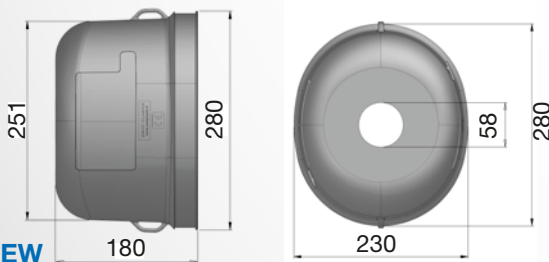

NEW

C2201C1 (ex MCP55/271)
C2281C1* e C2291C1+

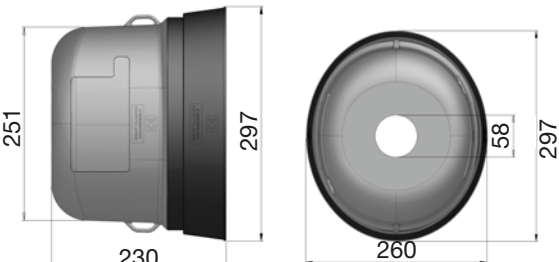

C2201L1 (ex MCP55/371)
C2281L1* e C2291L1+

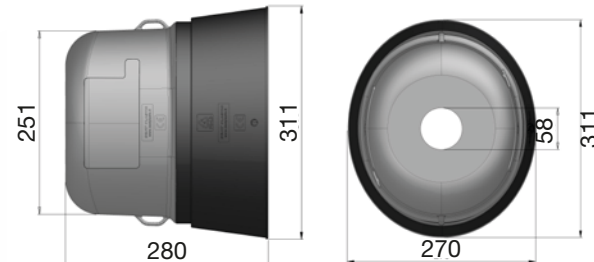

Optional

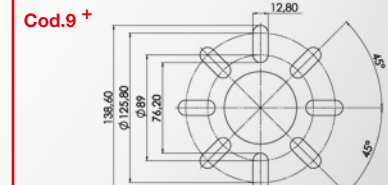
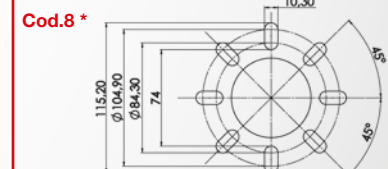



CONTROCUFFIA TIPO OVALONA / Super Oval Shaft Cone

C3001 (ex MCP32/101)
C3081*

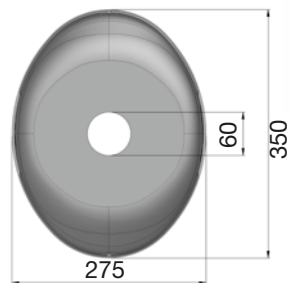

C3001C4 (ex MCP32/301)
C3081C4*

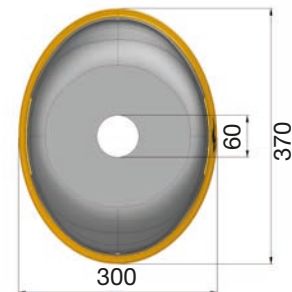
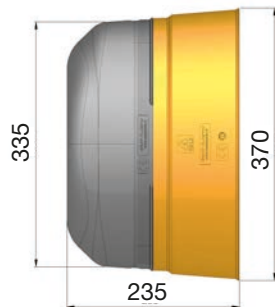

Optional

Cod.8 *

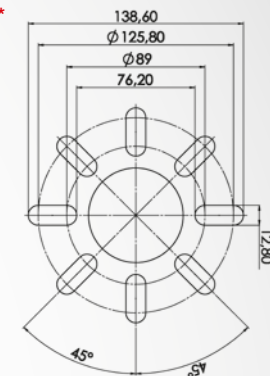

NEW



CONTROCUFFIA TIPO OVALONA: UNO SPORTELLO / Super Oval Shaft Cone: Single Window

C3101 (ex MCP32/201)
C3181*

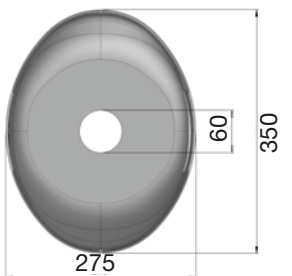
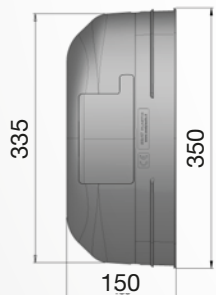

C3101C4 (ex MCP32/401)
C3181C4*

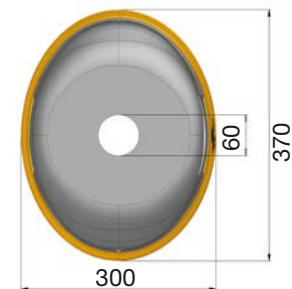
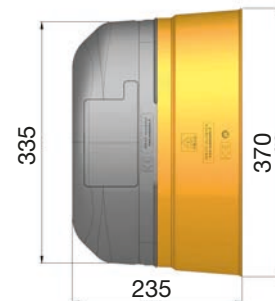

Optional

Cod.8 *

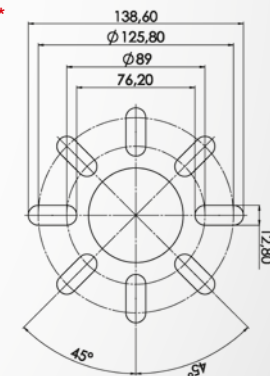

NEW

CUFFIA SFILABILE SECUR-PTO™

CONTROCUFFIE E GUAINE PER PRESE DI FORZA PTO Shaft Cone and PTO Caps

6INS0500

Fondello in alluminio
Alluminum bottom plate

diam 202

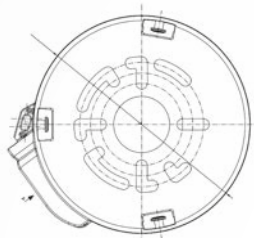

ESTENSIONI SFILABILI

Sliding protection

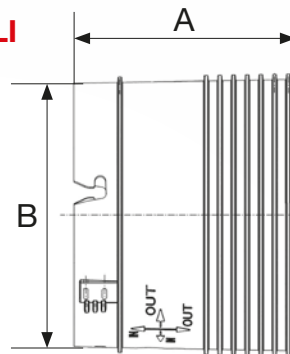

	A	B
C5001L160	160	190

6INS0520

Fondello in alluminio
Alluminum bottom plate

diam 227

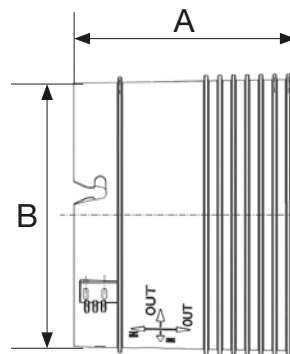
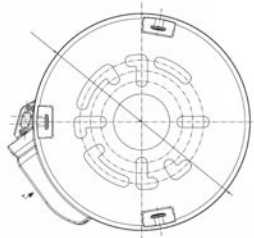

	A	B
C5201L160	160	215
C5201L210	210	215
C5201L250	250	215
C5201L320	320	215

6INS0540

Fondello in alluminio
Alluminum bottom plate

diam 253

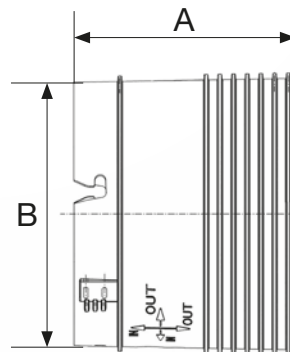
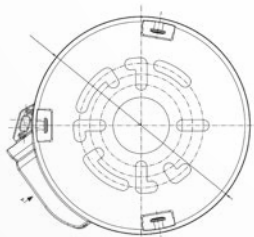

	A	B
C5401L210	210	240
C5401L230	230	240
C5401L250	250	240
C5401L280	280	240

FONDELLI IN METALLO
Metal bottom plate

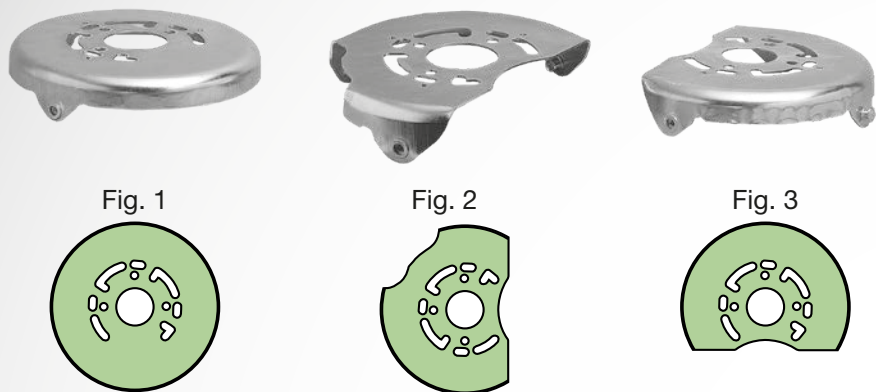

Codice fondello Code	Diametro mm Diameter mm	Descrizione dei fondelli in metallo Description	
MCP60/B1	230	pieno (Fig. 1)	solid (Fig. 1)
MCP60/B2	230	2 aperture (Fig. 2)	2 openings (Fig. 2)
MCP60/B3	230	apertura grande (Fig. 3)	large openings (Fig. 3)
MCP60/C1	205	pieno (Fig. 1)	solid (Fig. 1)
MCP60/C2	205	2 aperture (Fig. 2)	2 openings (Fig. 2)
MCP60/C3	205	apertura grande (Fig. 3)	large openings (Fig. 3)
MCP60/D1	180	pieno (Fig. 1)	solid (Fig. 1)
MCP60/D2	180	apertura grande (Fig. 3)	large openings (Fig. 3)

FASCE SFILABILI SEAT PLASTIC
Seat Plastic sliding protection

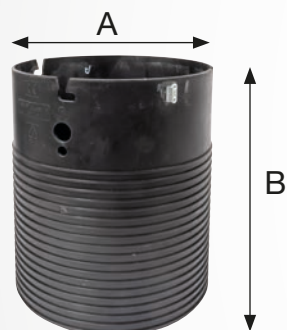

	A	B
C4001L160	190	160

	A	B
C4201L160	215	160
C4201L210	215	210
C4201L250	215	250
C4201L320	215	320

	A	B
C4401L160	240	160
C4401L210	240	210
C4401L230	240	230
C4401L250	240	250
C4401L280	240	280

FASCE SFILABILI MECCANOPLAST
Meccanoplast sliding protection

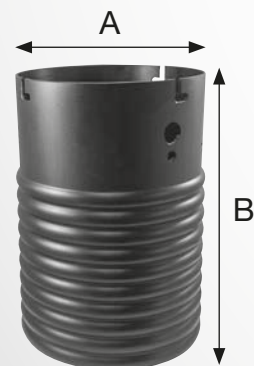

	A	B
MCP80/161	190	160
MCP80/211	190	210
MCP80/251	190	250

	A	B
MCP85/161	215	160
MCP85/181	215	180
MCP85/211	215	210
MCP85/251	215	250
MCP85/281	215	280

	A	B
MCP90/161	240	160
MCP90/211	240	210
MCP90/231	240	230
MCP90/251	240	250
MCP90/281	240	280

CONTROCUFFIE SFILABILI LISCE
Flat sliding protection

cod. MCP37/101

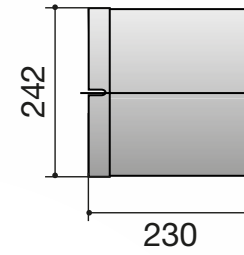
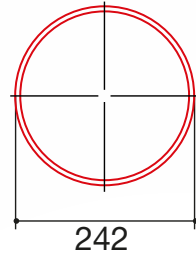
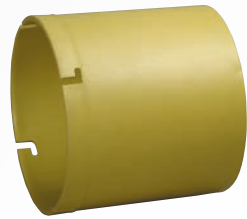

cod. MCP37/211

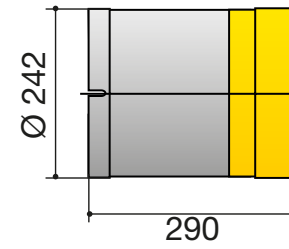
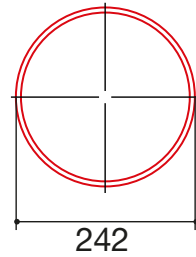

CONTROCUFFIA A SOFFIETTO

Bellows shaft cones

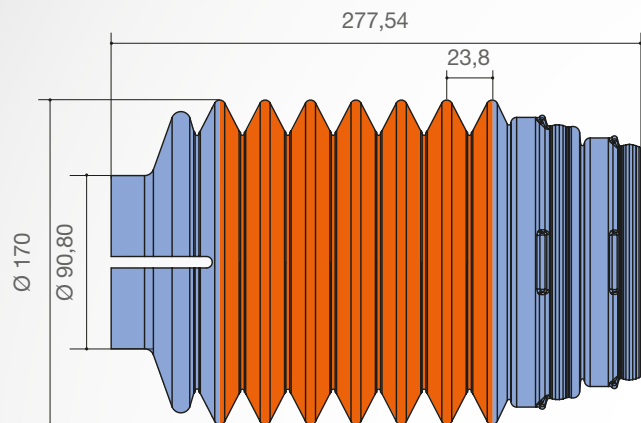

cod. MCP180/00



- Parte di soffietto realizzabile a richiesta (personalizzabile) | *Part of the bellows which can be done on request (customizable)*
- Modulo configurabile da 2 a 12 creste | *Module available from 2 to 12 ridges*

PROTEZIONE INTEGRALE A SOFFIETTO
Integral protection flexible cone

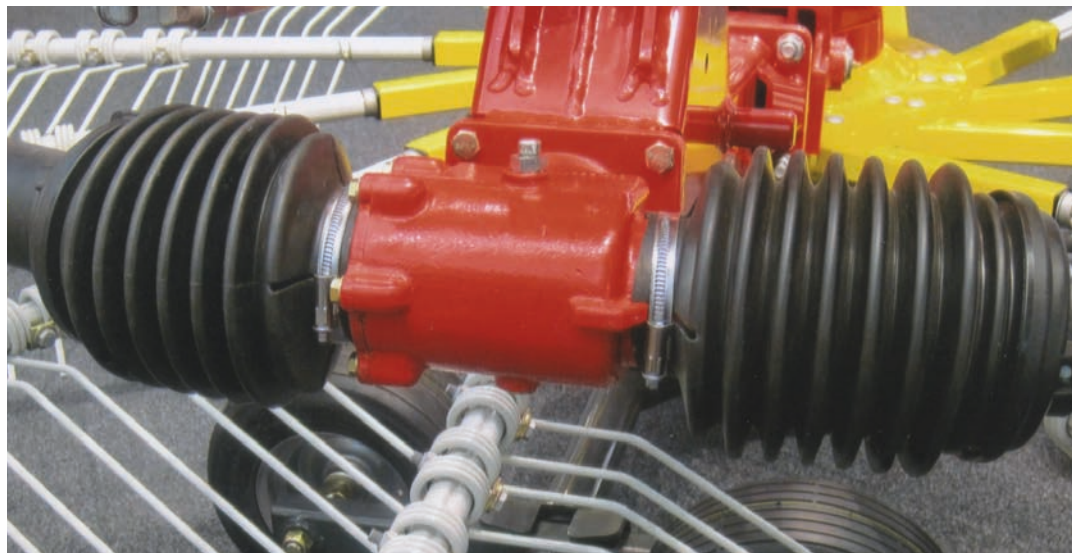



GUAINA PROTETTIVA PER PTO: 1" 3/8
Cover PTO: 1" 3/8

MP00084

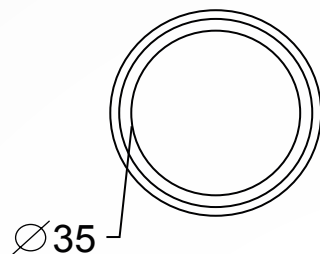
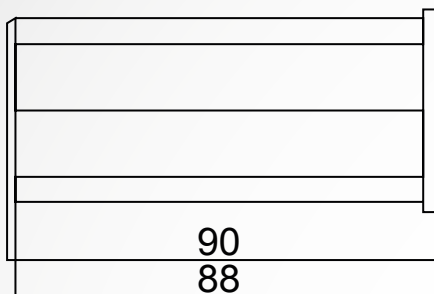

GUAINA PROTETTIVA PER PTO: 1" 3/4
Cover PTO: 1" 3/4

MP00209

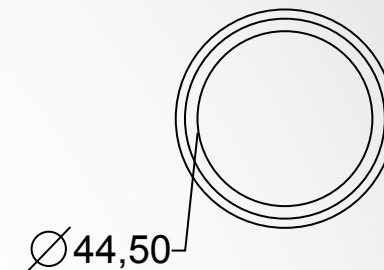
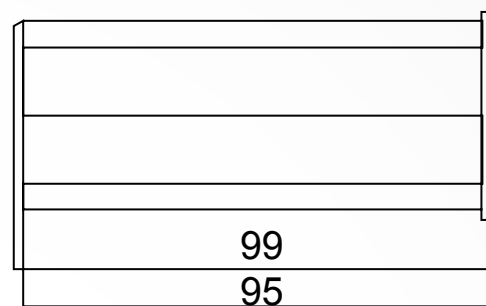

GUAINA PROTETTIVA FLANGIATA PER PTO
Flanged Cover PTO

C0904

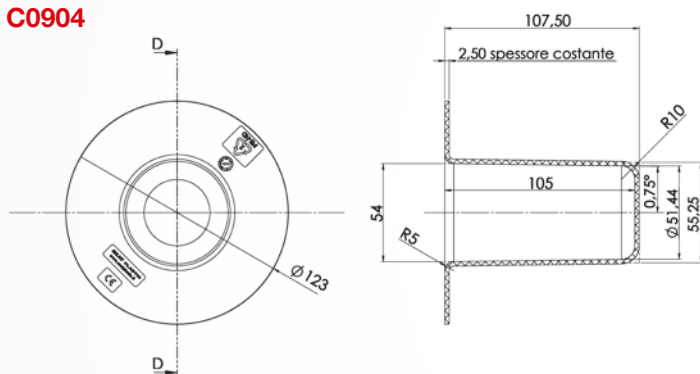

GUAINA PROTETTIVA FLANGIATA PER PTO: QUATTRO TAGLI
Flanged Cover PTO: Four Cuts

C0914

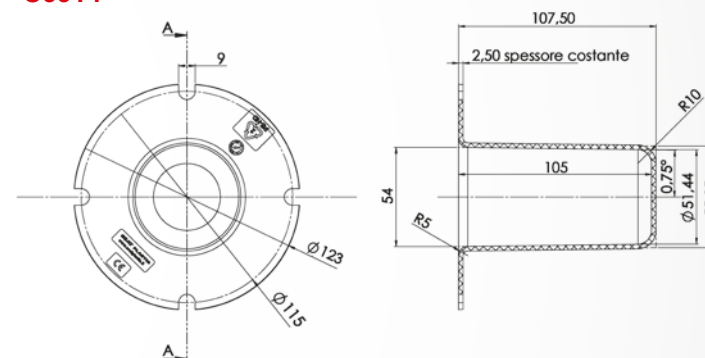

GUAINA PROTETTIVA FLANGIATA PER PTO: QUATTRO ASOLE
Flanged Cover PTO: Four Buttonholes

C0944

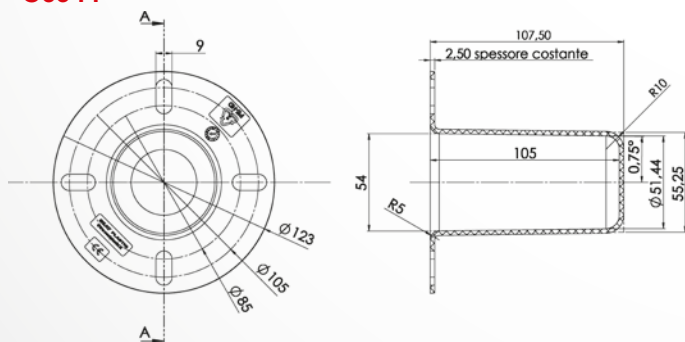

Per ordinare le Controcuffie dotate di foglio istruzioni, aggiungere la descrizione CE dopo il codice Articolo
Add CE description after the item code to order the Shaft Cones with instructions



- Operating Instructions
- 1 - Damaged Guard not be used and should be immediately replaced.
 - 2 - Do not step on Cone Guards.
 - 3 - 3-Cone Guard must overlap with Shaft Guard of minimum 50mm.
 - 4 - Mounting: ensure both screws and washers are properly tightened onto flat face of the Guard.



- Norme d'uso per le controcuffie.
- 1 - Non utilizzare controcuffie danneggiate.
 - 2 - Non usare la controcuffia come predellino.
 - 3 - La controcuffia deve sormontare la protezione dell'albero cardanico di almeno 50mm.
 - 4 - Fissaggio controcuffia: viti e rondelle devono essere contenute nella superficie piana di fissaggio e non devono risultare allentate.

ACCESSORI PER SEMINATRICI

Accessories for seeding machines



TUBI CONDUCISEMI Seed conveying tubes

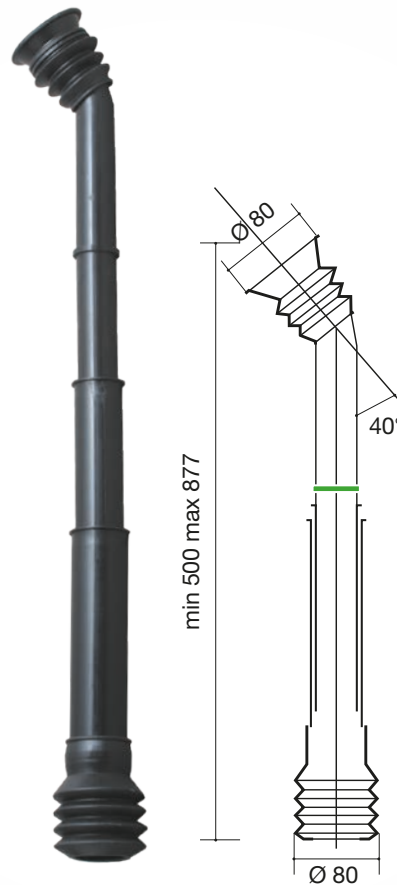

Tubo conducisemi lungo
Long seed conveying tube

cod. MCP22/10

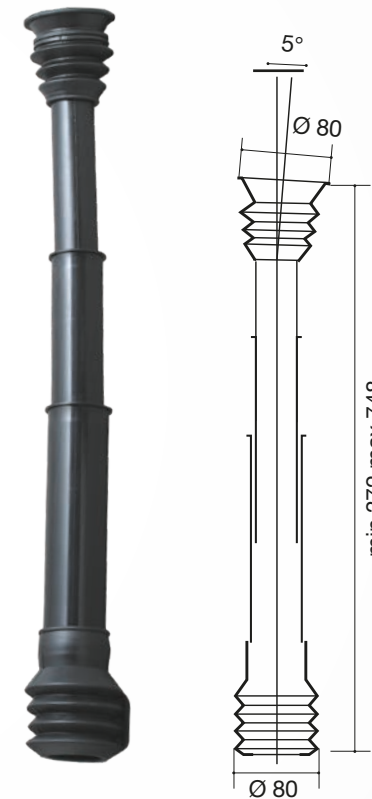

Tubo conducisemi corto
Short seed conveying tube

cod. MCP22/20



Soffietto conico
Conical bellows

cod. MCP22/30



Soffietto cilindrico
Cylindrical bellows

cod. MCP22/40



Bocchetta
cod. MCP24/10

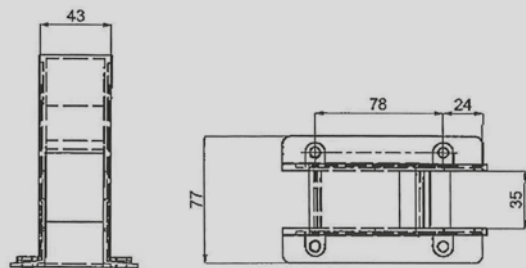

Chiusura
cod. MCP25/21



Cunetta
cod. MCP25/22



Registro
cod. MCP 25/23



Rondella
cod. MCP25/24



Rullino due corone
cod. MCP34/20



Rullino soia
cod. MCP34/10



**Rullino doppia
versione**
cod. MCP40/10



**Rullino
'semi grossi'**
cod. MCP34/60



Deviatore semi
cod. MCP29/30



Anti intasamento
cod. MCP29/40



**Imbuto per tubo
conducisemi**
cod. MCP29/10



Molla a spirale
cod. MCP25/A2



Molla sagomata
cod. MCP25/A1

ACCESSORI PER SEMINATRICE
Seeder machines accessories

NEW

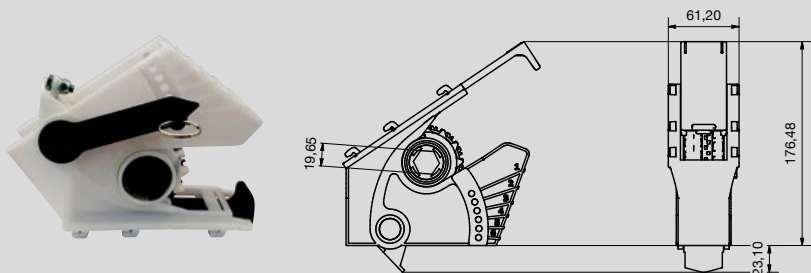

Distributore universale cereali
COD. MCP1003

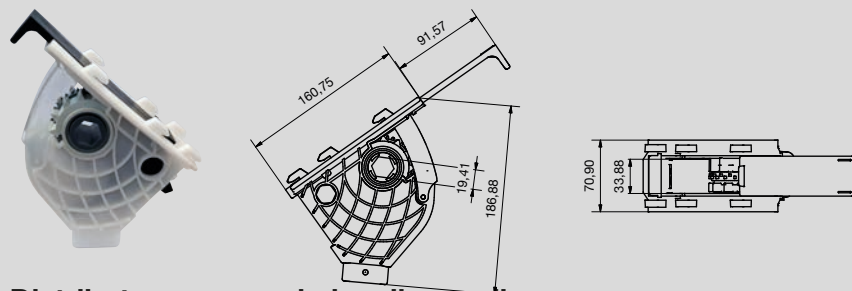

Distributore per semi piccoli e medi
COD. MCP1002

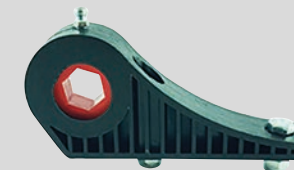

COD. MCP1005
Supporto ingranaggi

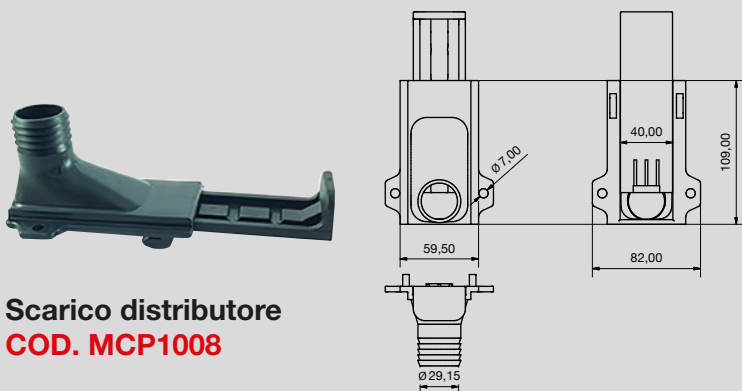

Scarico distributore
COD. MCP1008



Distributore per semi piccoli o microgranulari
COD. MCP1004

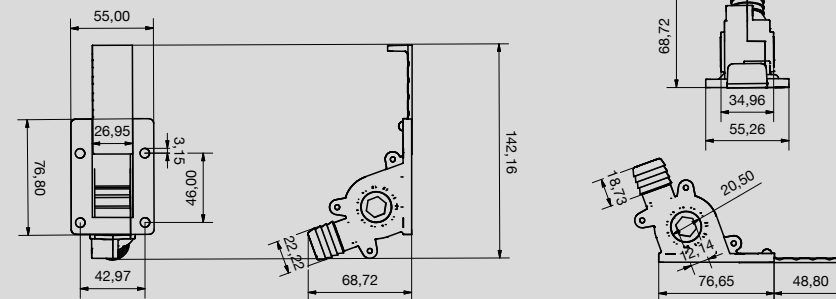

Regolatore tensione catena
COD. MCP1006



Cuscinetti segna file
COD. MCP1009

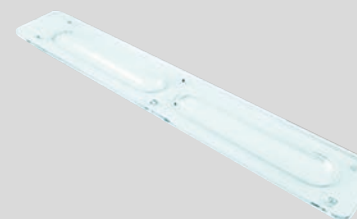

Vetrino vista livello semi
COD. MCP1010

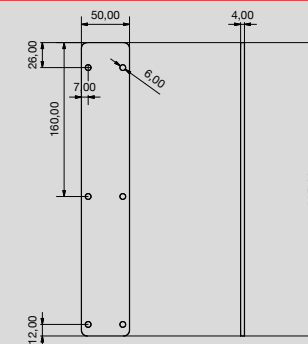

VARIATORE CONTINUO VELOCITÀ

CONTINUOUS SPEED VARIATOR

NEW

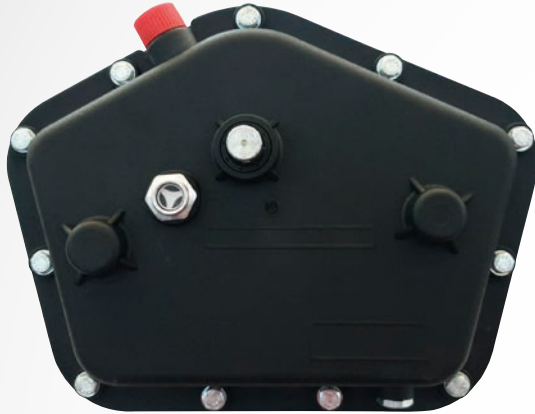

MCP1001



MCP1007
Connettore variatore

Variatore di giri

N°	Giri albero ingresso	Giri albero uscita	Rapporti	Indice
1	26	1	1/26	0,03846
2	67	4	4/67	0,05970
3	51	4	4/51	0,07843
4	49	5	5/49	0,10204
5	39	5	5/39	0,12821
6	65	10	10/65	0,15385
7	38	7	7/38	0,18421
8	32	7	7/32	0,21875
9	23	6	6/23	0,26087
10	10	3	3/10	0,30000

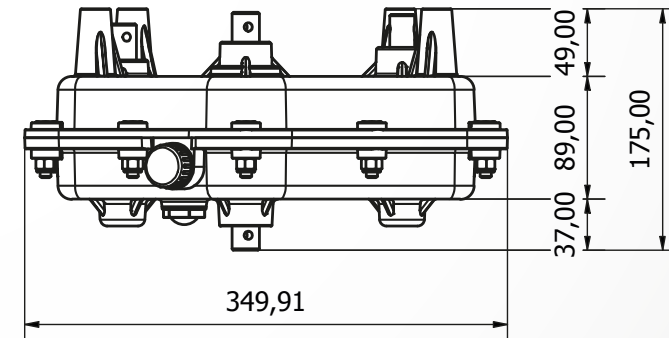
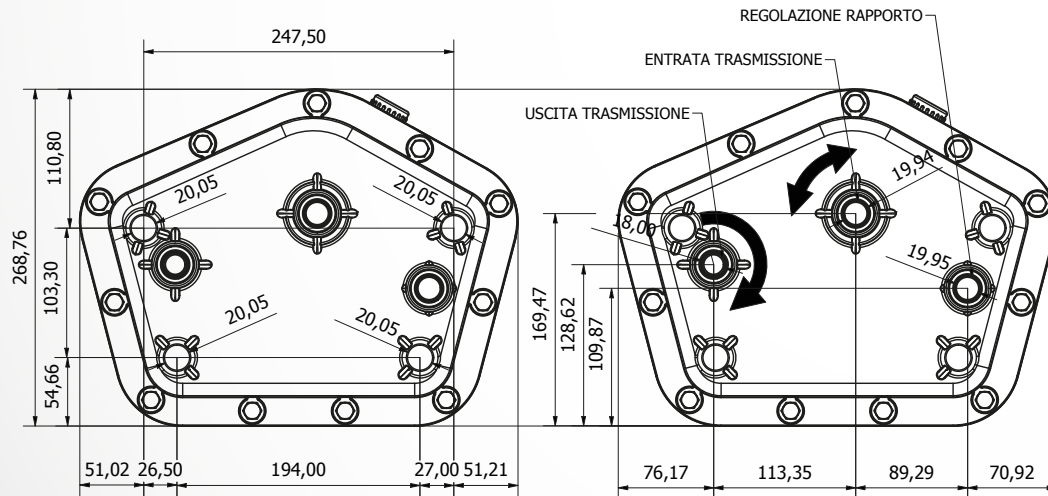

VARIATORE CONTINUO VELOCITÀ

CONTINUOUS SPEED VARIATOR

COD: 94454

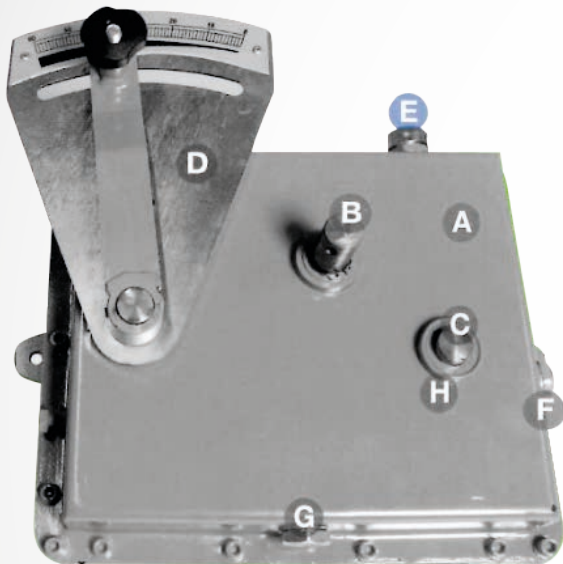

Il VARIATORE CONTINUO si distingue per la rotazione continua e priva di strappi, per la semplicità dell'utilizzo, è esente da manutenzione ed ha un dispositivo per il reset della scala graduata.

The CONTINUOUS SPEED VARIATOR offers smooth, continuous rotation, is simple to use, maintenance-free and features a device for resetting the graduated scale.

A	Semigusci scatola in lamiera laserata e a tenuta stagna Box half-shells in watertight laser-cut bent sheet metal
B	Albero motore predisposto per doppia trasmissione con speciale tornitura per tenuta olio Drive shaft pre-engineered for double transmission and specially turned to provide an oil seal
C	Cambio continuo a bagno d'olio con 3 camme per una rotazione uniforme CVT in oil bath with 3 cams for uniform rotation
D	Precisione e rapidità di taratura con pochi movimenti manuali Accurately and rapidly calibrated by just a few manual operations
E	Tappo carico con sfiato Drain plug
F	Tappo livello olio Oil level plug
G	Tappo scarico Drain plug
H	Paraolio a doppia tenuta Double oil seal

TAPPI DI PROTEZIONE PARAPOLVERE PER INNESTI RAPIDI

CAPS FOR HYDRAULIC QUICK COUPLING

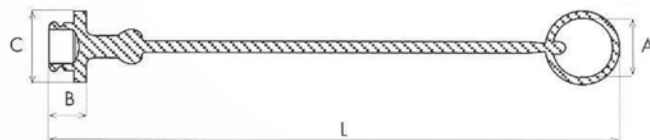
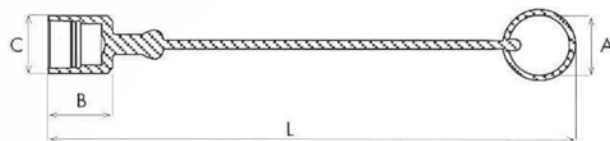
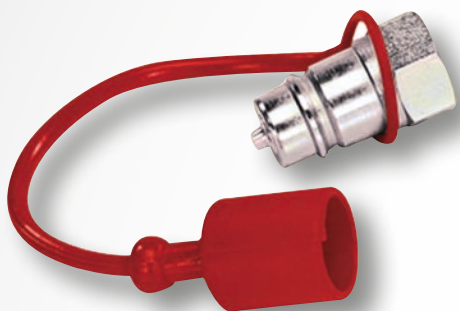

Tappo per innesto Maschio			Dimensioni mm.			
Dimensione	Colore	Codice	A	B	C	L
1/4"		MP00407	19	25	22	243
		MP00408				
		MP00435				
		MP00409				
		MP00410				
3/8"		MP00411	25	25	26	250
		MP00412				
		MP00232				
		MP00436				
		MP00413				
1/2"		MP00414	30	32	29	264
		MP00415				
		MP00116				
		MP00437				
		MP00416				

Tappo per innesto Femmina			Dimensioni mm.			
Dimensione	Colore	Codice	A	B	C	L
1/4"		MP00421	19	15	24	235
		MP00422				
		MP00438				
		MP00423				
		MP00424				
3/8"		MP00425	25	16	30	240
		MP00426				
		MP00233				
		MP00439				
		MP00427				
1/2"		MP00428	30	19	32	242
		MP00429				
		MP00117				
		MP00440				
		MP00430				

MANOPOLE Knobs

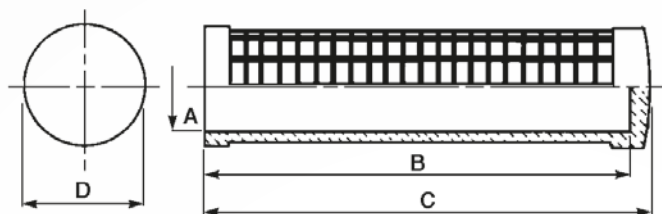

Art./Ref.	A mm	B mm	C mm	D mm	Materiale/ Material	Pos.
MP00325	20-21	112	116	24	PVC	1
MP00477	22	118	123	33	PVC	2
MP00113	25	118	123	33	PVC	2
MP00018	27	118	123	33	PVC	2
MP00680	28	118	123	33	PVC	2

POMOLI FORO LISCIO KNOBS

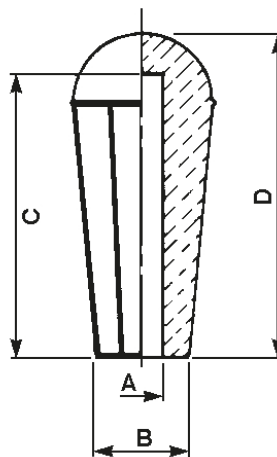

Art./Ref.	A mm	B mm	C mm	D mm
MP00308	8	15	50	56
MP00287	10	15	50	56
MP00180	12	15	50	56

MANOPOLE PIATTE RIGATE KNOBS

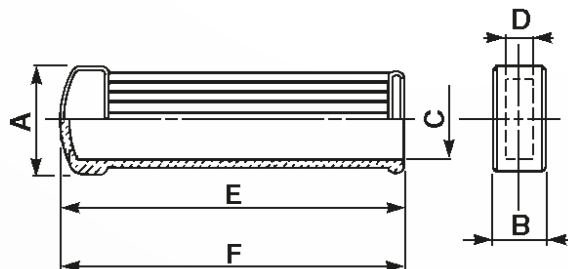

Art./Ref.	A mm	B mm	C mm	D mm	E mm	F mm
MP00112	34	18	25	10	105	108
MP00388	38	20	30	15	108	111



La SEAT PLASTIC è nata alcuni anni fa come produttrice di stampi ad iniezione e più recentemente ha creato al proprio interno un reparto di stampaggio che le consente di fornire un servizio globale: dalla progettazione del particolare alla realizzazione dello stampo allo stampaggio del prodotto finito.

Uno staff specializzato ed un parco macchine tra le più innovative del settore danno la possibilità alla SEAT PLASTIC di realizzare stampi in acciaio e in alluminio di piccole e grandi dimensioni. Le presse di cui dispone, che hanno una potenza tra le 30 e le 800 tonnellate, possono stampare ad iniezione particolari da 1 gr. a 3,8 Kg. in tutti i tipi di materiali termoplastici: nylon, resine acetaliche, abs, polietilene, polipropilene ecc. Il prodotto viene gestito su stazioni CAD-CAM ed è controllato in tutte le fasi di lavorazione per garantire una costante qualità del pezzo finito. L'elasticità produttiva, l'esperienza e la capacità di collaborare celermente con la clientela, fanno della SEAT PLASTIC il partner ideale nella produzione di complessi particolari di ogni tipo di stampi.

L'azienda è certificata ISO 9001 – ISO 14001. Dal 2007 è stato attrezzato un nuovo reparto per la produzione di articoli per l'alimentare prodotti conformemente alla direttiva BRC che regola il settore.



SEAT PLASTIC was founded several years ago as a Manufacturer of Injection Moulds: afterwards, a dedicated Molding Department was added allowing a full service to be provided to Customers.

SEAT PLASTIC is capable to assist Customers starting from the Design activity of the plastic Component, full Design and Engineering of the Moulds, Part Prototyping, Part Serial Production.

Dedicated Staff and Mechanical Machining Department support construction of both Steel and Aluminum Moulds of any size.

Range of Injection Molding Machines from 30 to 800 Tons allows production of Components from 1gr up to 3.8Kg, within different material options: Nylon, Acetal Resins, Abs, Polyethylene, Polypropylene, or others.

Manufacturing Molding Process is continuously monitored, plastic Parts are fully inspected with dedicated Equipments before being delivered to Customers.

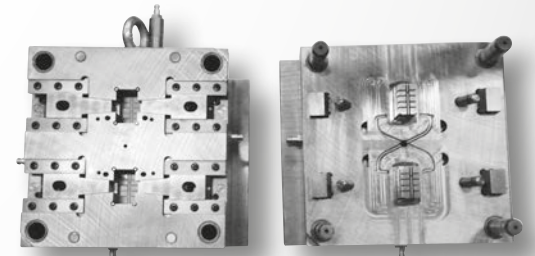



Stampaggio materie plastiche
Costruzione stampi

Via Domenico Tosi, 8 - Mancasale
42124 Reggio Emilia - ITALY
Tel. 0522/911870 - Fax 0522/912498
info@seatplastic.it - www.seatplastic.it

